

PICCADILLY COURT - UPPER GROUND FLOOR

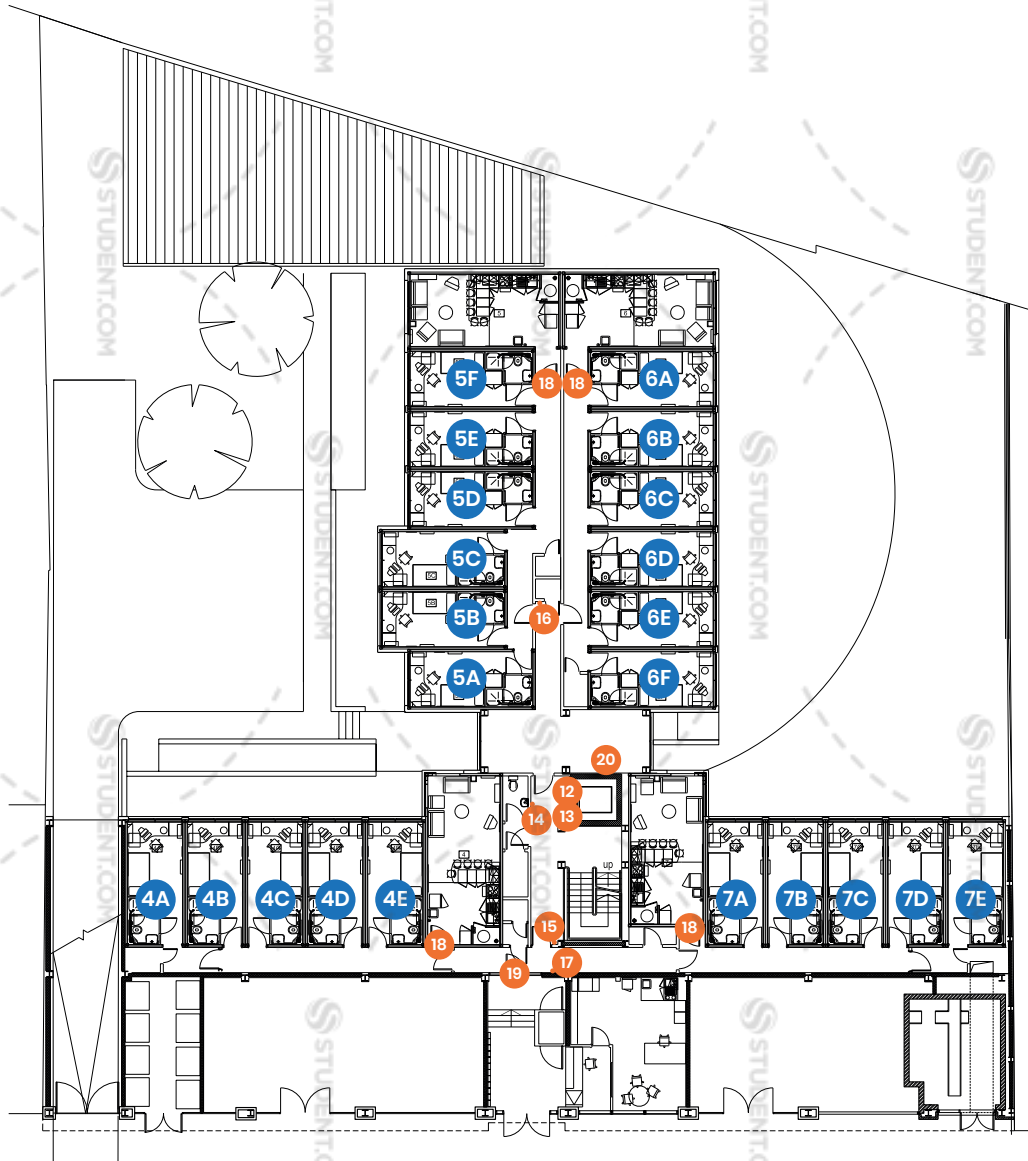

SIGN COLOUR

Pantone 447C
RAL 9004 (matt)

Pantone 108C
RAL 1018 (matt)

Pantone 427C
RAL 9018 (matt)

White
RAL 9910 (matt)

Black
RAL 9005 (matt)

BRAND TYPEFACES

Primary :
Lato Regular

Secondary :
Open Sans



COPYRIGHT:
THE ATTACHED DESIGN AND ILLUSTRATION ARE HEREBY SOLELY OWNED BY UNITE STUDENTS LTD AND SHOULD ONLY BE USED BY THOSE TO WHOM THIS DESIGN SPECIFICATION IS ADDRESSED.
THE CONTENTS ARE STRICTLY PRIVATE AND CONFIDENTIAL AND FORM NO PART OF UNITE STUDENTS LTD'S INFORMATION. ANY REPRODUCTION, COPIING, DISSEMINATION, MODIFICATION OR ALTERATION OF THIS DOCUMENT IS STRICTLY PROHIBITED. UNITE STUDENTS LTD COMPANY NO. 10325890.
REGISTERED ADDRESS:
ASHLEIGH HOUSE, RECOVERIDGE ROAD, NORMANTON INDUSTRIAL ESTATE, NORMANTON, WILTSHIRE, WILT, SN4 8JH

UNITE STUDENTS
PICCADILLY COURT
457-483 CALEDONIAN ROAD
LONDON
N7 9BJ

167778
03/02/22 - KA